

# DO NOT REMOVE OR TIGHTEN AIR FITTING ON THE NEW PART



## REMOVAL



Prior to inserting the existing air line into the new air fitting you will need to remove the old original equipment air line fitting.

## INSTALLATION



Arnett parts come with pre-installed air line fittings for your convenience. **Do not remove or tighten.**

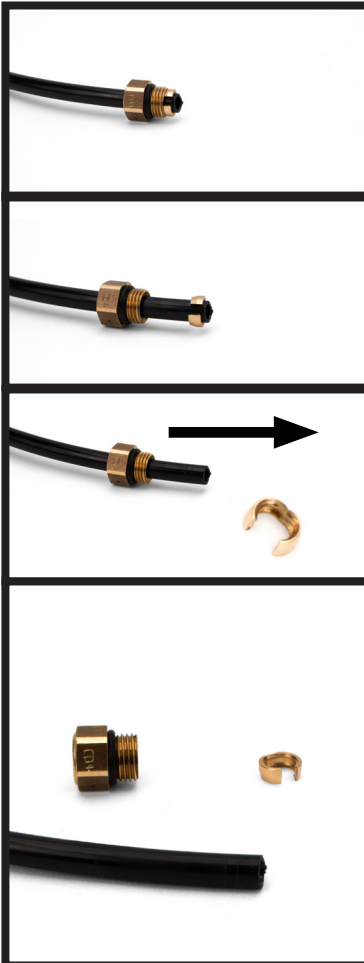

- #1  
OE AIR LINE FITTING
- #2  
SLIDE THE THREADED PORTION UP THE LINE AND SPREAD THE COLLET OPEN TO REMOVE
- #3  
SLIDE THE AIR FITTING OFF OF THE AIR LINE
- #4  
AIR LINE IS READY FOR INSTALLATION

**NOTE:** SCRATCHES AND/OR DEEP CUTS IN THE AIR LINE CAN RESULT IN POSSIBLE LEAKS. INSPECT THE AIR LINE BEFORE INSERTION. AIR LINE NEEDS TO BE REPLACED IF DAMAGED.

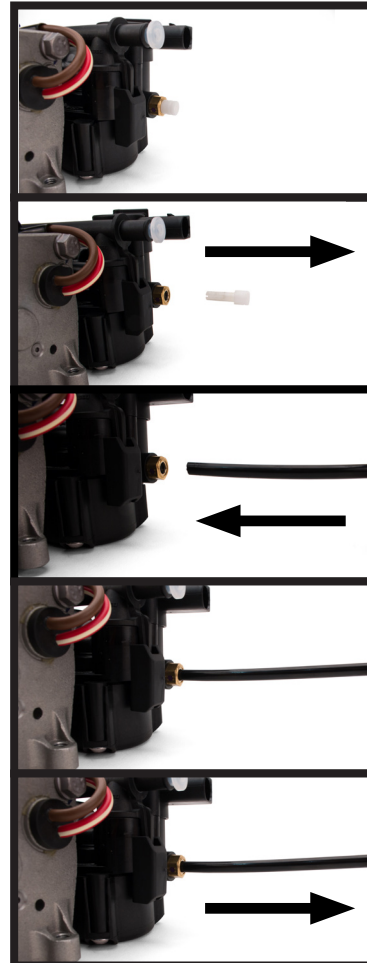

- #1  
AS RECEIVED
- #2  
REMOVE & DISPOSE OF SHIPPING PIN
- #3  
INSERT THE AIR LINE INTO THE FITTING AND PRESS UNTIL FIRMLY SEATED
- #4  
AIR LINE INSERTED
- #5  
PULL AIR LINE OUTWARD TO LOCK AND ENSURE A SECURE CONNECTION

Arnett® is committed to the quality of its products. If you have a question or problem with any Arnett product, please contact Arnett by calling 800-251-8993 during normal business hours or email [techassistance@arnottinc.com](mailto:techassistance@arnottinc.com). (In the EU please call +31 (0)73 7850 580 or email [info@arnotteurope.com](mailto:info@arnotteurope.com))